



EM3L-10 is a high torque series AC brushless motor. This low speed and high inertia model is designed for high-torque applications. The motor is supplied with modern 23-bit optical or 17-bit magnetic absolute encoder. Optional 24VDC brake is available.

## Technical data

Output power	1000 W
Rated speed	1000 rpm
Maximum speed	1500 rpm
Rated torque	9.5 Nm
Maximum torque	31 Nm
Rated current	3.1 A
Maximum current	10 A
Motor inertia (motor without brake)	22.3 kg*cm <sup>2</sup>

## Technical data

Motor inertia (motor with brake)	22.9 kg*cm <sup>2</sup>
Allowable radial shaft load	980 N
Allowable axial shaft load	392 N
Optional brake holding torque	≥20 Nm
Optional brake voltage	24 VDC
Weight (motor without brake)	8.3 kg
Weight (motor with brake)	10 kg
Flange	130 mm

## Speed-torque curves

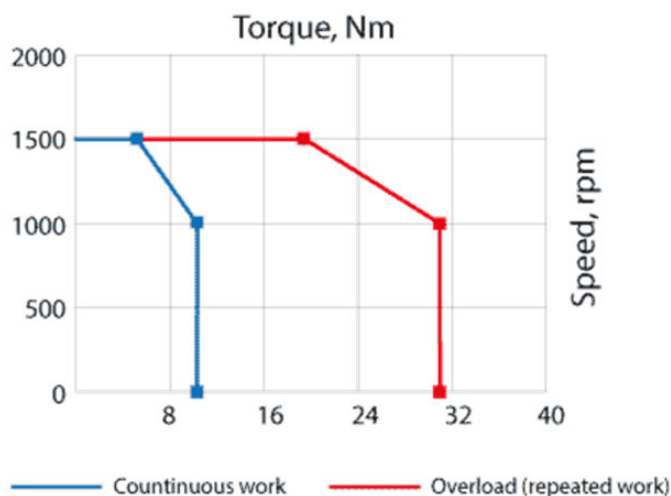

## Available motor models

Motor model	Encoder	Brake	Servo drive	Input drive supply voltage
EM3L-10DLA224	absolute optic encoder, resolution 23-bit (8 388 608 ppr)	-	ED3L-10DMA ED3L-10DEA ED3L-10DPA	Three phase AC 380V...440V
EM3L-10DLA244		✓		
EM3L-10DTA224	absolute magnetic encoder, resolution 17-bit (131 072 ppr)	-		
EM3L-10DTA244		✓		

## Dimensions of AC servo motor EM3L-10

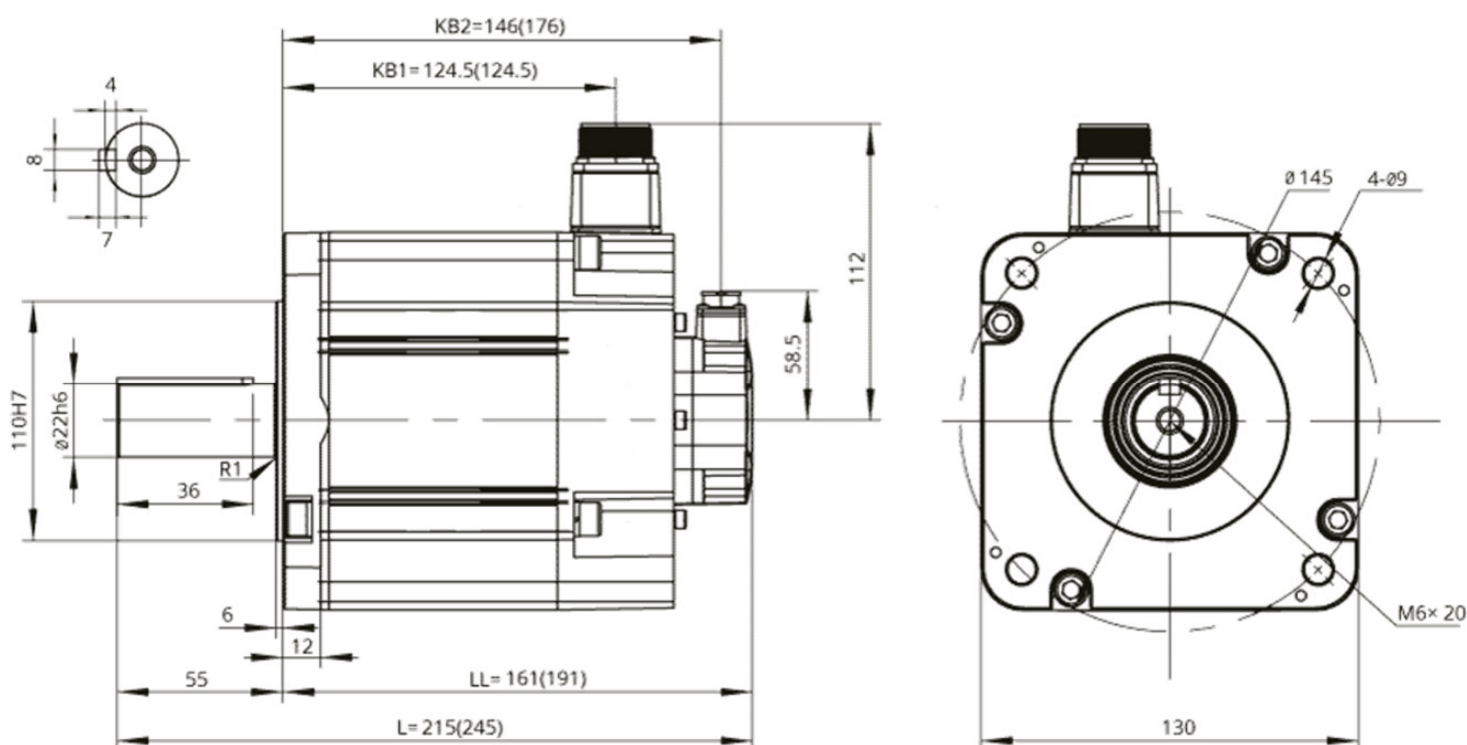

Note: The values in parentheses represent the values of motors with brakes

