



High-torque AC synchronous servo motor EM3L-20 is specially designed to provide low speed motion with increased force at the motor shaft. The motor is supplied with high resolution 23-bit optical or 17-bit magnetic absolute encoder. Optional 24VDC brake is available.

Technical data

Output power	2000 W
Rated speed	1000 rpm
Maximum speed	1500 rpm
Rated torque	19.1 Nm
Maximum torque	69 Nm
Rated current	5.2 A
Maximum current	20.2 A
Motor inertia (motor without brake)	58.5 kg*cm ²

Technical data

Motor inertia (motor with brake)	64.6 kg*cm ²
Allowable radial shaft load	1470 N
Allowable axial shaft load	490 N
Optional brake holding torque	≥44 Nm
Optional brake voltage	24 VDC
Weight (motor without brake)	17.6 kg
Weight (motor with brake)	21.8 kg
Flange	180 mm

Speed-torque curves

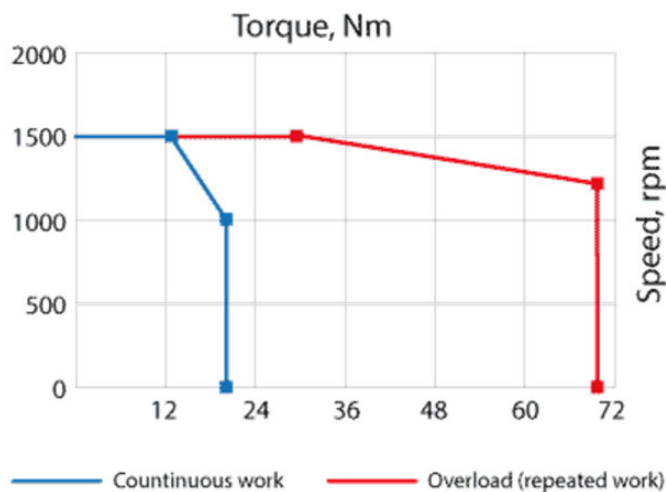

Available motor models

Motor model	Encoder	Brake	Servo drive	Input drive supply voltage
EM3L-20DLA224	absolute optic encoder, resolution 23-bit (8 388 608 ppr)	-	ED3L-20DMA ED3L-20DEA ED3L-20DPA	Three phase AC 380V...440V
EM3L-20DLA244		✓		
EM3L-20DTA224	absolute magnetic encoder, resolution 17-bit (131 072 ppr)	-		
EM3L-20DTA244		✓		

Dimensions of AC servo motor EM3L-20

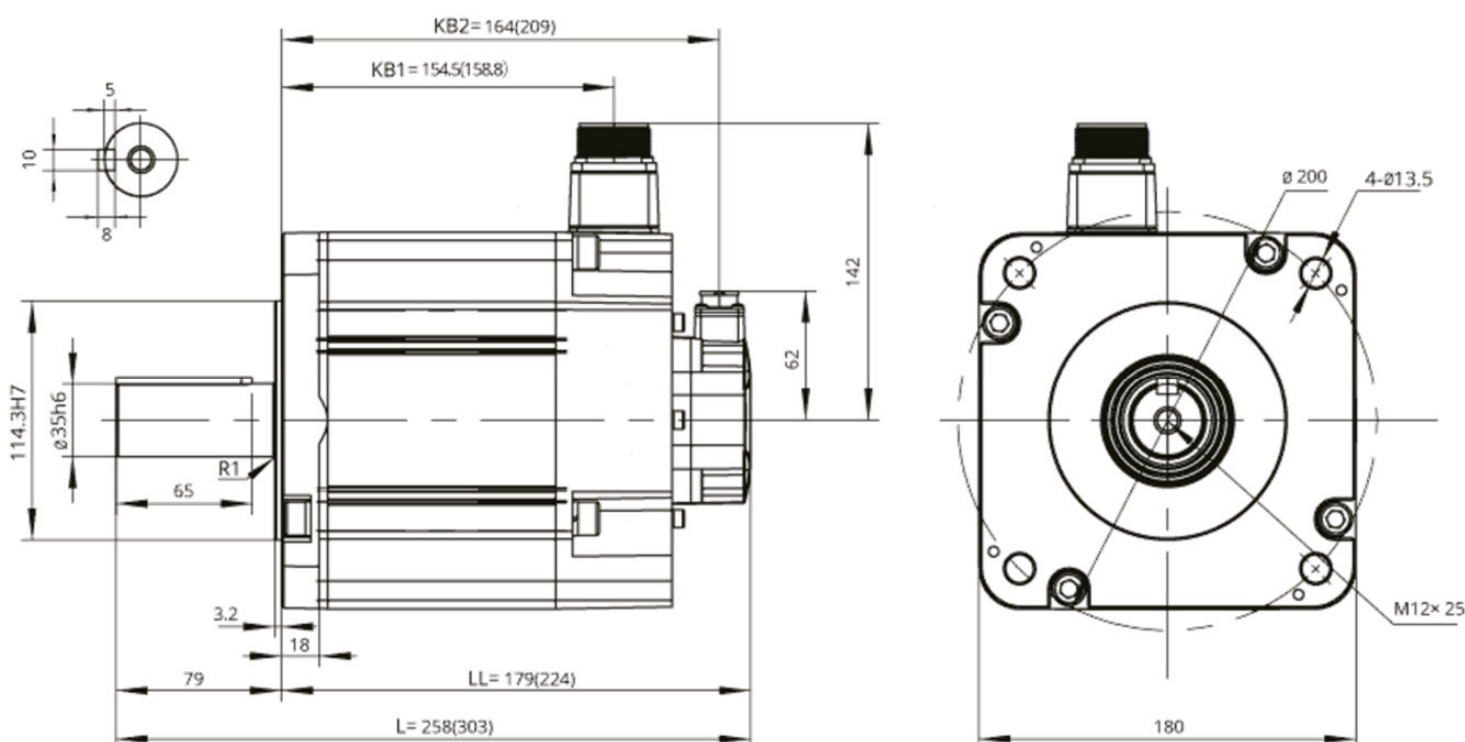

Note: The values in parentheses represent the values of motors with brakes

