

Dimension	Tolerance
5 h9	$\begin{matrix} 0 \\ -0.030 \end{matrix}$

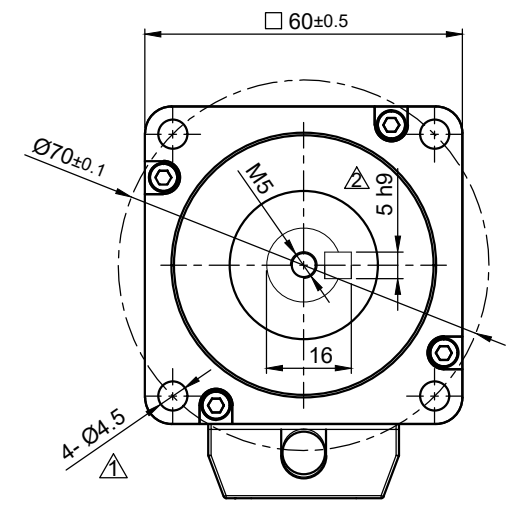
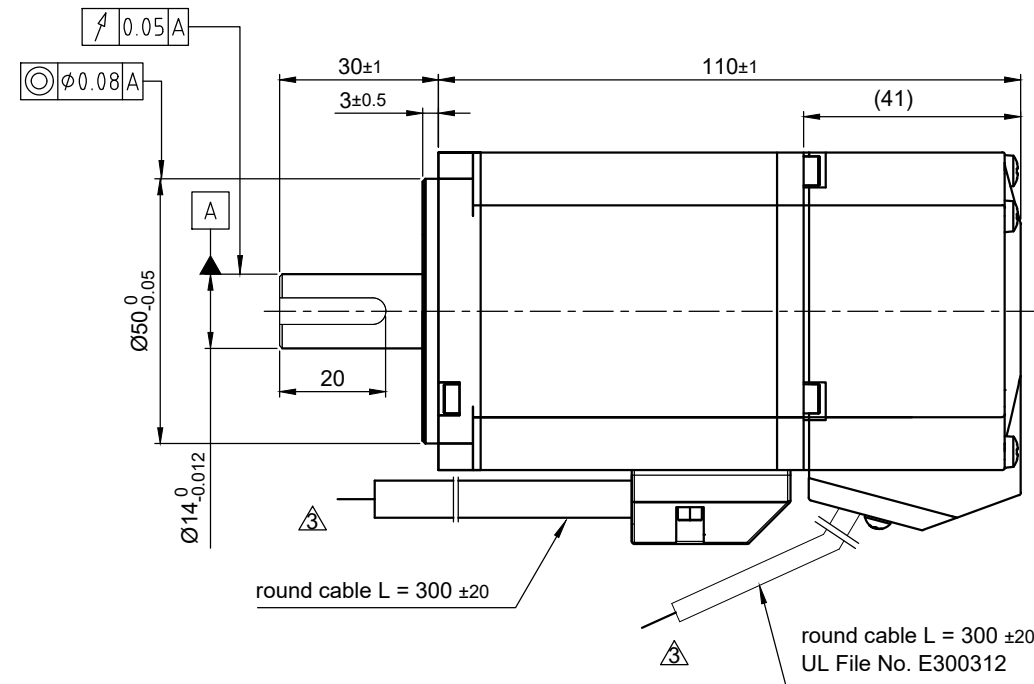
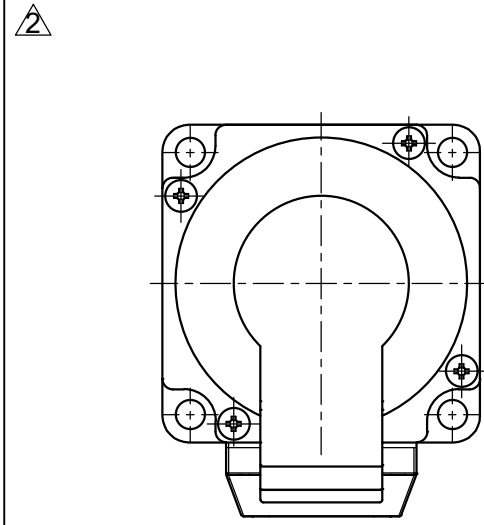

round cable L = 300 ±20

round cable L = 300 ±20
UL File No. E300312

MOTOR SPECIFICATION		
No. of Poles		8
Rated Voltage	V DC	48
Current - No Load / Rated / Peak	A	1.27 / 6 / 18
Resistance Line to Line	±10% Ω	0.56
Inductance Line to Line (1kHz)	±20% mH	1.2
Torque - Rated / Peak	Nm	0.64 / 1.92
Torque Constant	Nm/A	0.107
Rated Power	W	200
Speed - No Load / Rated	±10% rpm	5200 / 3000
Rotor Inertia	kg m ²	21 × 10 ⁻⁶

GENERAL MOTOR SPECIFICATION		
Ambient Temperature	°C	-20 ... 40
Max. Temperature Rise (at standstill)	°C	90
Max. Ambient Humidity (non condensing)	%	90
Insulation Class		B
Insulation Resistance	MΩ	100
Dielectric Strength (for 1 min - coil to case)	V AC	500
Protection Class		IP65

WIRING DIAGRAM			
Motor	Colour	Function	Lead Gauge
	YE	U	UL758 AWG16
	RD	V	
	BK	W	

ENCODER SPECIFICATION		
Operating Voltage	±5% V DC	+5 V
Resolution	cpr	2500
Resolution (cpr with quadrature)	ppr	10000
No. of Channels		3
Signal Type		incremental
Index / Line Driver		yes / yes

PIN Assignment Encoder	
Colour	Function
RD	+5V
BK	GND
-	-
BN/BK	H1+
BN	H1-
YE	I+
GN	B+
BU/BK	A+
GY/BK	H3+
WH/BK	H2+
YE/BK	I-
GN/BK	B-
BU	A-
GY	H3-
WH	H2-
-	Shield

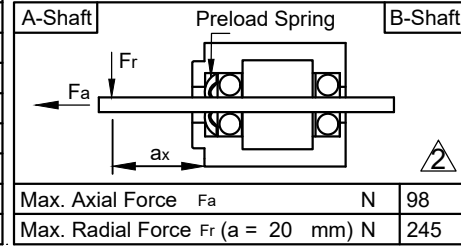
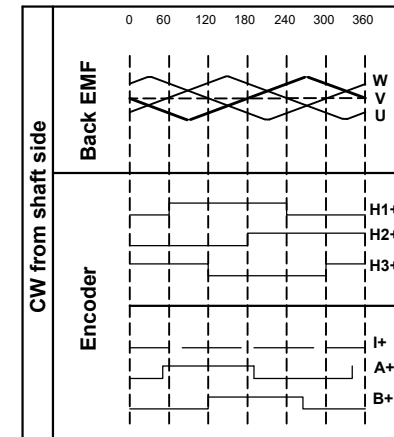

Max. Axial Force Fa	N	98
Max. Radial Force Fr (a = 20 mm)	N	245

ISO 8015	ISO 1302	ISO 2768 cK	ISO 13715
03	revise drawing	Schneid_A	24.11.2020
02	revise drawing	Schneid_A	08.01.2020
01	Change spec.&Motor L	Garcia_E	29.11.2019
REV	Rev. Text	Name	Date



Date		Name	
Drawn	11.07.2019	Schneid_A	
Reviewed	24.11.2020	Hofstet_M	
Released	24.11.2020	Hofstet_M	
04200040		APBA60M048030-E	
State: Released	Rev: 03	CONFIDENTIAL	A4 Page 1

