



The FL39ST34-0306A is known for being one of the most user-friendly stepper motor models available. It operates with a supply voltage of 12V in quasi-static mode, making it a popular choice for a wide range of applications. These stepper motors find extensive use in small-sized devices, lighting equipment, miniature dispensers, medical equipment, and for solving automation challenges in technological processes that demand precise, rapid, and cost-effective actuator positioning. They are commonly employed in various automated systems such as 3D printers, CNC machines, engraving machines, scanners, and other mechanized mechanisms.

## Technical parameters

Holding Torque	Step angle	Step angle accuracy	Phase current	Phase resistance	Phase inductance	Number of phases / leads	Rotor inertia	Weight
1,3 kg*cm	1,8 deg	±5%	0,3 A	40 Ohm	20 mH	2 / 6	20 g*cm <sup>2</sup>	0,18 Kg

## Dimensions

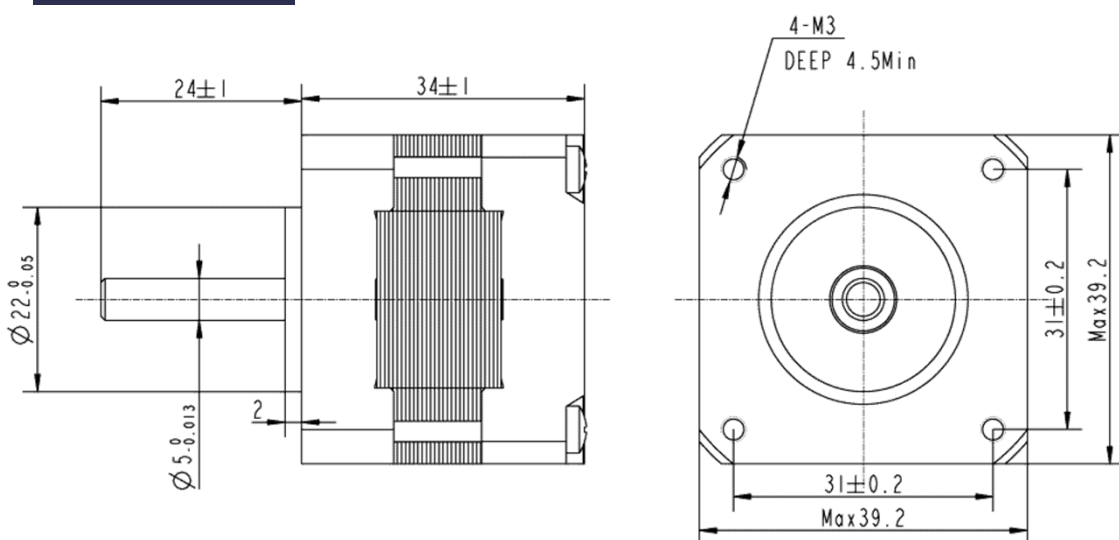

## Wiring diagram

